

# Mini Maintenance Kit

**Part #:**  
**PJ096MINI-H**

**D45RE15 - 20 GPM**



GENUINE  
**DOSATRON**  
PARTS

1-800-523-8499  
www.dosatronusa.com



## Kit Contents:

**M072 and P170:** DOSA-LUBE:  
Check valve spring and cone  
2.5 grams silicone



Use **Dosa-Lube** on specified parts only.



**J051:** Check valve seal



**J009:** Plunger seal



**STOP CAUTION:** Parts may contain concentrated chemicals. The use of Proper Protective Equipment is recommended when performing maintenance.

## Instructions

(Parts included in kit noted in blue)

### Disassembly

1. Remove hose nut (P150) and hose from the unit and set these two items aside.

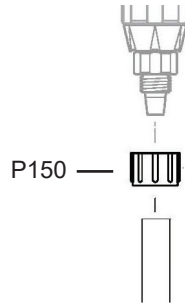

2. Unscrew the check valve barb (PDI1212). Remove and discard the check valve seal (J051), the check valve spring (M072), and the check valve cone (P170).

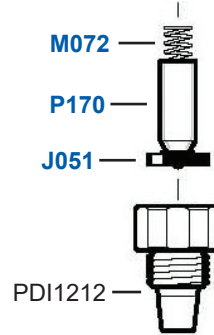

3. Using a Phillips screw driver, remove the four screws (M337) from the silver plate (M079) at the base of the unit.

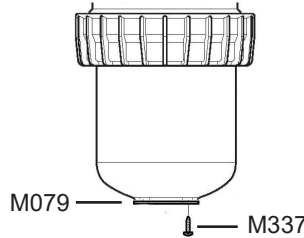

4. Remove the injection stem assembly (CD070), exposing the plunger seal (J009). Remove the plunger seal by squeezing the seal and rolling it off. Discard seal.

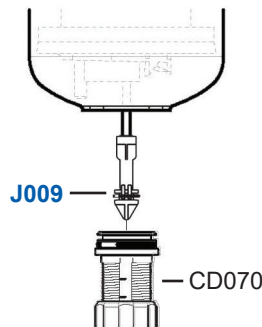

5. Unscrew the lower locking nut (P168) and set aside. Remove the locking ring (P189).

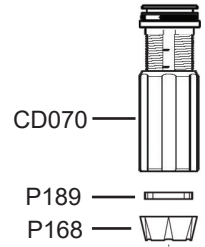

6. Unscrew the adjusting sleeve (P167) and push up the white injection stem (PJ121) through the black sleeve (PE003), to separate them.

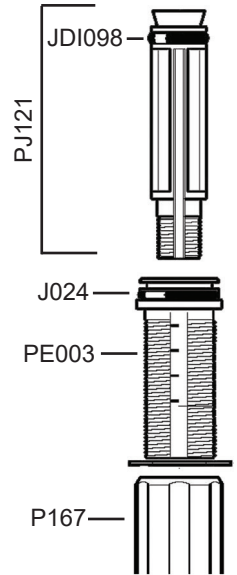

**NOTE:** Reassembly instructions on back.

**!** To remove seal easily without tools, squeeze it on either side to raise the seal, then slide it over the groove. Using sharp tools could damage the plunger.

## Reassembly

- Take the new plunger seal (**J009**) and place it on the groove at the tip of the plunger (P390). Roll the seal on.

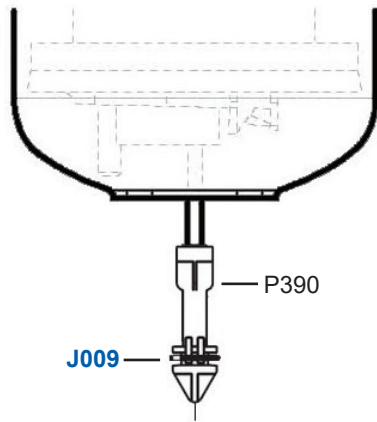

**NOTE:** Do not apply **Dosa-Lube** to plunger parts.

- Using the **Dosa-Lube** provided, rub a small amount on the black sleeve o-ring (J024) and the injection stem o-ring (JDI098).

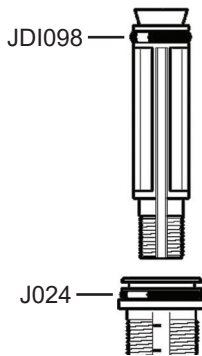

- Re-insert the injection stem (PJ121) back into the sleeve (PE003), make sure the black key inside the sleeve is aligned with the long groove on the white stem. Push the stem (PJ121) down as far as it will go.

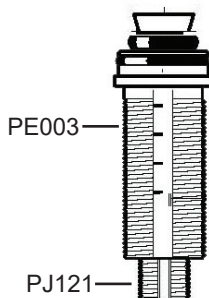

- Screw the outer black sleeve (P167) onto the injection sleeve (PE003) and reposition the black locking ring (P189), making sure the two keys on the black locking ring line up with the two grooves in the white injection stem (PJ121).

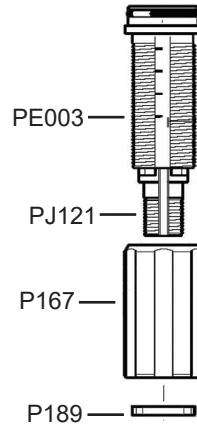

- Replace the check valve spring and cone (**M072/P170**), and the check valve seal (**J051**), with the new parts. Make sure the groove on the seal (**J051**) faces up toward the check valve cone (**P170**). Screw hose barb (PDI1212) back onto the white injection stem.

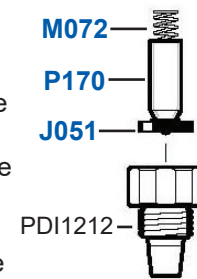

- Cut 1" off from the top of the suction hose to ensure a tight fit, make sure to cut in a straight line. Attach the hose and the hose nut (P150) back to the unit.

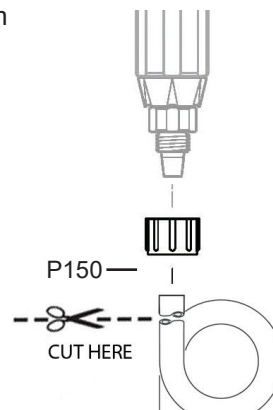

*Don't forget to reset your injection rate to the proper ratio.*